

- ① 22mm NBK TERRART Eco Terracotta Tile
- ② CLP22 NBK Extruded Aluminum clip with EPDM Gasket
- ③ EVT- Alum. Extruded Carrier Track (Black Anodized)
- ④ Z-Girt 12 Ga [50ksi Galvanized steel A653] (Not by NBK)
- ⑤ $\frac{1}{4}$ "-14 x $\frac{3}{4}$ " (6.3 x 19 mm) PPH S.S. fastener (Not by NBK)
- ⑥ $\frac{1}{4}$ "-14 x 2" HWH S.S. Bi-Flex or approved equal (Not by NBK)
- ⑦ Insulation per design (Not by NBK)
- ⑧ $\frac{5}{8}$ " GYP Board sheathing with air & vapor barrier membrane (Not by NBK)
- ⑨ Vertical Steel Stud Framing, min. 16 Ga. @ 16" O.C. (Not by NBK)
- ⑩ NBK PVC spacer PT-01 (Optional)
- ⑪ Shim as required (Not by NBK)

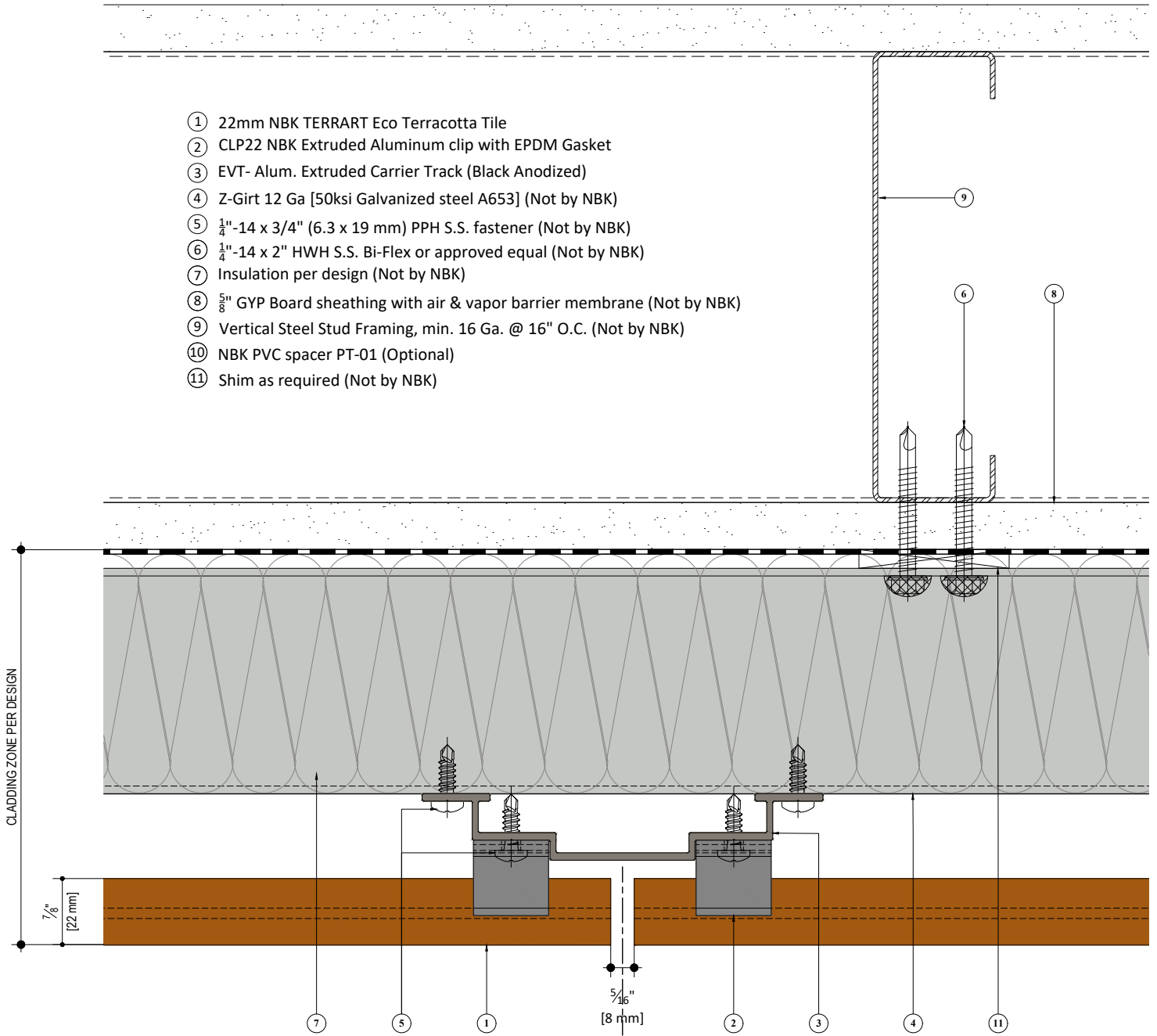

SYSTEM:
TERRART 22 ECO

DETAIL:
STANDARD STUDWALL DETAIL

DETAIL NUMBER:
NBK-22-01

TILE DIRECTION:
HORIZONTAL

DRAWING REFERENCE:
HORIZONTAL SECTION

SCALE:
1:2

NBK | ARCHITECTURAL
TERRACOTTA
A Hunter Douglas Company

NBK North America

10 Federal Street, Second Floor
Salem, MA 01970
Telephone: +1 (781) 639 2662
www.nbkterracotta.com